



ARIA - Universal polyester cabinets

- Ergonomic closing mechanism
- A two point locking mechanism and operated by swing-handle (for profile half cylinder locks)
- Reducing closing force by 25%
- Patented doorlifter ensuring the door taking the center position during closing (as from ARIA 75)
- Self-adhesive rainhood as a standard accessory with each cabinet

Standards

IEC 61439-2
IEC 60529
EN 61439-2
EN 60529
IEC 62208
EN 62208

Approvals



UL types 3, 3R, 3S, 4, 4X,
12 and 13
available on request



CSA types 3, 3R, 3S, 4, 4X,
12 and 13
available on request



Lloyd's Register of Shipping

Features

- The range is available in seven sizes, ranging from 300 x 200 to 1000 x 800 mm.
- The cabinets are made of light-grey (RAL 7035) hot moulded, glass fibre reinforced polyester, dyed in mass. The enclosure is furnished with four threaded studs and bolts for mounting plate or mounting frame installation.
- The enclosure provides total insulation and a protection degree of **IP65/IP66** following EN/IEC 60529.
- Protection degree IK10 against external mechanical impacts according to EN/IEC 62262. (IK07 for cabinets with glazed door)
- Resists temperatures up to 70°C in continuous use (peak temperatures up to 130°C).
- Self extinguishing and halogen-free.
- Rated insulation voltage $U_i = 1000V$.

Applications

- | | |
|--|------------------------|
| - Heavy industry | - Brewery |
| - Steel mills | - Public services |
| - Petrochemical plants | - Street signalisation |
| - Temporary connection
(for construction sites) | - Photovoltaic |



ARIA

Universal polyester cabinets

IP65/66/IK7/10



Cabinets
IK10

Size	Ref. No.	Pack.
With plain door		
ARIA 32 cabinet 300 x 200 x 170 - with double bit lock 3mm, one point closing system	831025	1
ARIA 43 cabinet 400 x 300 x 170 - with double bit lock 3mm, three point closing system	831036	1
ARIA 43 cabinet 400 x 300 x 170 - with handle, three point closing system	831034	1
ARIA 54 cabinet 500 x 400 x 230 - with double bit lock 3mm, two point closing system	831809	1
ARIA 54 cabinet 500 x 400 x 230 - with double bit lock 3mm, three point closing system	831052	1
ARIA 54 cabinet 500 x 400 x 230 - with handle, three point closing system	831051	1
ARIA 64 cabinet 600 x 400 x 230 - with double bit lock 3mm, two point closing system	831810	1
ARIA 64 cabinet 600 x 400 x 230 - with double bit lock 3mm, three point closing system	831065	1
ARIA 64 cabinet 600 x 400 x 230 - with handle, three point closing system	831064	1
ARIA 75 cabinet 700 x 500 x 270 - with double bit lock 3mm, two point closing system	831811	1
ARIA 75 cabinet 700 x 500 x 270 - with double bit lock 3mm, three point closing system	831081	1
ARIA 75 cabinet 700 x 500 x 270 - with handle, three point closing system	831080	1
ARIA 86 cabinet 800 x 600 x 300 - with double bit lock 3mm, three point closing system	831098	1
ARIA 86 cabinet 800 x 600 x 300 - with handle, three point closing system	831097	1
ARIA 108 cabinet 1000 x 800 x 300 - with double bit lock 3mm, three point closing system	831112	1
ARIA 108 cabinet 1000 x 800 x 300 - with handle, three point closing system	831111	1



IK7

With glazed door		
ARIA 43 cabinet 400 x 300 x 170 - with double bit lock 3mm, three point closing system	831815	1
ARIA 54 cabinet 500 x 400 x 230 - with double bit lock 3mm, two point closing system	831812	1
ARIA 54 cabinet 500 x 400 x 230 - with double bit lock 3mm, three point closing system	831129	1
ARIA 64 cabinet 600 x 400 x 230 - with double bit lock 3mm, two point closing system	831813	1
ARIA 64 cabinet 600 x 400 x 230 - with double bit lock 3mm, three point closing system	831130	1
ARIA 75 cabinet 700 x 500 x 270 - with double bit lock 3mm, two point closing system	831814	1
ARIA 75 cabinet 700 x 500 x 270 - with double bit lock 3mm, three point closing system	831131	1
ARIA 86 cabinet 800 x 600 x 300 - with double bit lock 3mm, three point closing system	831132	1
ARIA 108 cabinet 1000 x 800 x 300 - with double bit lock 3mm, three point closing system	831133	1



Mounting plates

In pertinax 5 mm		
ARIA 32 mounting plate 250 x 150 x 5	831027	1
ARIA 43 mounting plate 350 x 250 x 5	831038	1
ARIA 54 mounting plate 450 x 350 x 5	831054	1
ARIA 64 mounting plate 550 x 350 x 5	831067	1
ARIA 75 mounting plate 650 x 450 x 5	831083	1
ARIA 86 mounting plate 750 x 550 x 5	831100	1
ARIA 108 mounting plate 950 x 750 x 5	831114	1

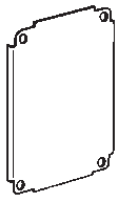

In sendzimir zinc coated sheet steel 2 mm		
ARIA 32 mounting plate 250 x 150 x 2	831026	1
ARIA 43 mounting plate 350 x 250 x 2	831037	1
ARIA 54 mounting plate 450 x 350 x 2	831053	1
ARIA 64 mounting plate 550 x 350 x 2	831066	1
ARIA 75 mounting plate 650 x 450 x 2	831082	1
ARIA 86 mounting plate 750 x 550 x 2	831099	1
ARIA 108 mounting plate 950 x 750 x 2	831113	1

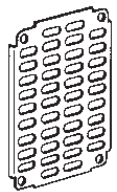

Perforated sheet steel 1.5 mm		
ARIA 32 mounting plate 250 x 150 x 1.5	831322	1
ARIA 43 mounting plate 350 x 250 x 1.5	831333	1
ARIA 54 mounting plate 450 x 350 x 1.5	831334	1
ARIA 64 mounting plate 550 x 350 x 1.5	831335	1
ARIA 75 mounting plate 650 x 450 x 1.5	831336	1
ARIA 86 mounting plate 750 x 550 x 1.5	831337	1
ARIA 108 mounting plate 950 x 750 x 1.5	831338	1



Mounting frames

ARIA 32 mounting frame 2 rows	831030	1
ARIA 43 mounting frame 2 rows	831041	1
ARIA 54 mounting frame 3 rows	831057	1
ARIA 64 mounting frame 3 rows	831070	1
ARIA 75 mounting frame 4 rows	831086	1
ARIA 86 mounting frame 4 rows	831103	1
ARIA 108 mounting frame 5 rows	831117	1

Universal polyester cabinets

IP65/66/IK7/10

Full cover plates

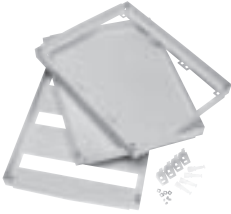

Size	Ref. No.	Pack.
Plain plates		
ARIA 32 cover plate	831028	1
ARIA 43 cover plate	831039	1
ARIA 54 cover plate	831055	1
ARIA 64 cover plate	831068	1
ARIA 75 cover plate	831084	1
ARIA 86 cover plate	831101	1
ARIA 108 cover plate	831115	1
With cut-outs for DIN-rail equipment		
ARIA 32 plate for DIN-rail equipment	831029	1
ARIA 43 plate for DIN-rail equipment	831040	1
ARIA 54 plate for DIN-rail equipment	831056	1
ARIA 64 plate for DIN-rail equipment	831069	1
ARIA 75 plate for DIN-rail equipment	831085	1
ARIA 86 plate for DIN-rail equipment	831102	1
ARIA 108 plate for DIN-rail equipment	831116	1
With cut-outs for individual modular cover plates		
ARIA 43 cover plate	831790	1
ARIA 54 cover plate	831791	1
ARIA 64 cover plate	831792	1
ARIA 75 cover plate	831793	1
ARIA 86 cover plate	831794	1
ARIA 108 cover plate	831795	1

Individual modular cover plates (PVC) IP20



Plain plates		
ARIA 43 cover plate - 150 x 239	831797	1
ARIA 54 cover plate - 150 x 343	831799	1
ARIA 64 cover plate - 150 x 343	831801	1
ARIA 75 cover plate - 150 x 423	831803	1
ARIA 86 cover plate - 150 x 239	831797	1
ARIA 108 cover plate - 150 x 343	831801	1
With cut-outs for DIN-rail equipment		
ARIA 43 cover plate for DIN-rail equipment - 150 x 239	831796	1
ARIA 54 cover plate for DIN-rail equipment - 150 x 343	831798	1
ARIA 64 cover plate for DIN-rail equipment - 150 x 343	831800	1
ARIA 75 cover plate for DIN-rail equipment - 150 x 423	831802	1
ARIA 86 cover plate for DIN-rail equipment - 150 x 239	831796	1
ARIA 108 cover plate for DIN-rail equipment - 150 x 343	831800	1

Rail for terminal blocks

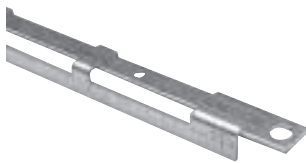

Rail for terminal blocks ARIA 32	831018	1
Rail for terminal blocks ARIA 43	831019	1
Rail for terminal blocks ARIA 54/64	831020	1
Rail for terminal blocks ARIA 75	831021	1
Rail for terminal blocks ARIA 86	831022	1
Rail for terminal blocks ARIA 108	831023	1

Accessories

Set hinge supports	831010	1
Set fixing lugs polyamide	831001	1
Set fixing lugs stainless steel	831000	1
Set ventilation grids	831009	1
Neutral handle	831003	1
Handle	831004	1
Handle for profile half cylinder	832024	1
Handle for profile half cylinder for padlocking	832023	1
Triangular 8 lock core	831006	1
Square lock 8 mm	831005	1
Triangular 11 lock core	831007	1
Double-bit lock core	831008	1
Nuts M4	831328	1
Nuts M5	831329	1
Nuts M6	831330	1
Pocket for drawing	832000	1